

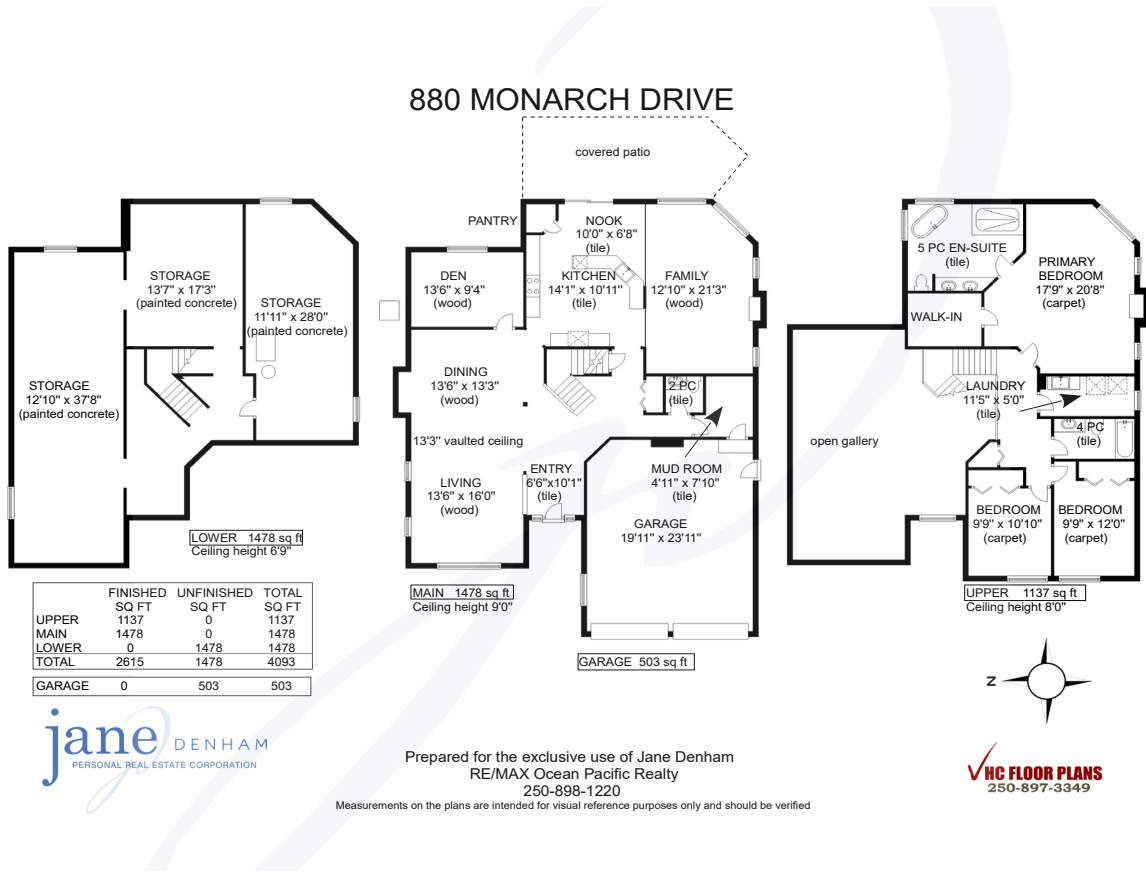

880 Monarch Drive





Indulge in the serenity...

Indulge in the serenity of this peaceful backyard oasis. Sip morning coffee and evening cocktails under the stunning Timber frame pergola. Designed for entertaining, this executive home of 2,615 sf on the main and 2nd floors, offers an additional 1,478 sf in the 6'9" basement ideal for a media room and/or home business with lots of storage space. Striking roof lines and architectural details complement the vaulted ceilings in the formal living and dining rooms. Those with a culinary flair will love this spacious kitchen w/ gas range, s/s appliances, maple shaker cabinets, quartz counter space, pantry, and access to the patio. The adjacent family room shares the warmth & ambience of the gas fireplace. Upstairs the primary suite provides a relaxing retreat w/ gas f/p, gorgeous ensuite w/ freestanding tub and walk-in tile & glass shower & dual vanities. This ideal location is only a short stroll to all the amenities, Starbucks, Costco, new Hospital, & Crown Isle's golf course & clubhouse.





880 Monarch Drive | Listed at \$1,050,000

---

MLS #: 456581 | 3 Bedrooms | 3 Bathrooms

Fin. SqFt:	2,615
Unfin. SqFt:	1,478
Total SqFt:	4,093
Garages:	2
Lot Size:	0.23 acres
Year Built:	1998
Zoning:	CD-1B

---

Please use the link below for property photos, virtual tour & video:  
**<https://www.janedenham.com/property/880-monarch-drive/>**



c 250.898.1220  
jane@janedenham.com  
www.janedenham.com



**RE/MAX**

ocean pacific realty

Each Office Independently Owned and Operated

b 250.339.2021  
tf 888.829.7205  
282 Anderton Rd.  
Comox BC V9M 1Y2