



15-523 Island Highway





15 - 523 ISLAND HIGHWAY

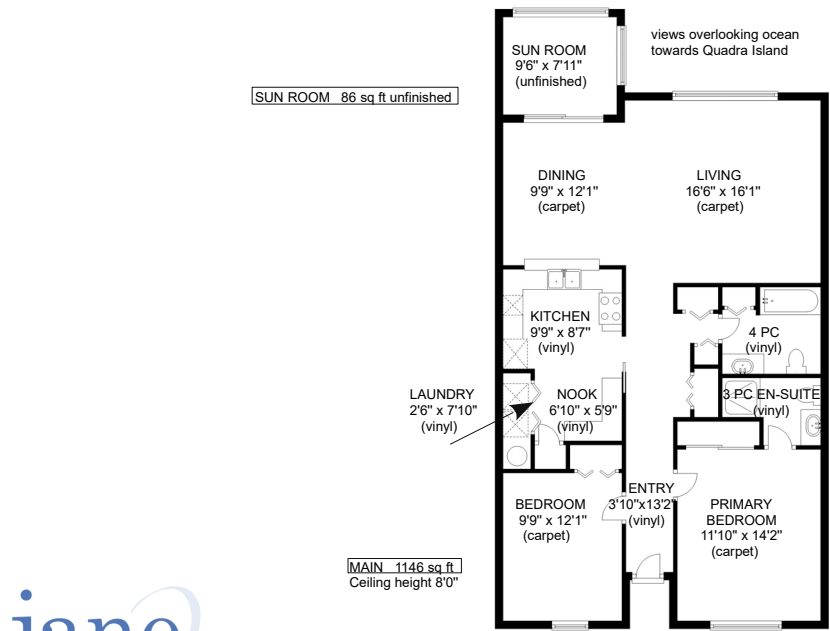

jane DENHAM  
PERSONAL REAL ESTATE CORPORATION

Prepared for the exclusive use of Jane Denham  
RE/MAX Ocean Pacific Realty  
250-898-1220

Measurements on the plans are intended for visual reference purposes only and should be verified

Clearview Floor Plans  
250 - 331 - 2564

Eagle View Oceanfront Condo...

Eagle View Oceanfront Condo located on the top floor, 2 BD/ 2 BA, 1,146 sf boasting a central location with easy walking distance to all downtown amenities and the Fishing Pier! Enjoy fantastic views of Discovery Passage, Quadra Island and the Coast mountains from the kitchen and the large windows in the great room. The enclosed sunroom showcases walls of windows and partial glass ceiling, relax and enjoy the marine traffic, abundant wildlife and the Perseid meteor showers! This lovely condo has been well cared for, with updated kitchen by previous owners, new washer and dryer 2021, new hot water tank 2020, all kitchen appliances 2015. With 2 spacious bedrooms and good-sized closets, one offers a 3 pce ensuite with walk-in shower. Elevator access, wheelchair accessible, secure entry, storage room on lower level, covered parking, adult oriented 45+, no rentals, 1 dog or 1 cat.



jane DENHAM  
PERSONAL REAL ESTATE CORPORATION



15-523 Island Highway | Listed at \$425,000

---

MLS #: 884027 | 2 Bedrooms | 2 Bathrooms

Fin. SqFt:	1,146
Unfin. SqFt:	86
Total SqFt:	1,232
Strata Fees:	\$395 / mth
Year Built:	1979
Zoning:	RM-3

---

Please use the link below for property photos, floor plan & virtual tour:  
**<https://www.janedenham.com/property/15-523-island-highway/>**



c 250.898.1220  
jane@janedenham.com  
www.janedenham.com



**RE/MAX**®

ocean pacific realty

Each Office Independently Owned and Operated

b 250.339.2021  
tf 888.829.7205  
282 Anderton Rd.  
Comox BC V9M 1Y2