

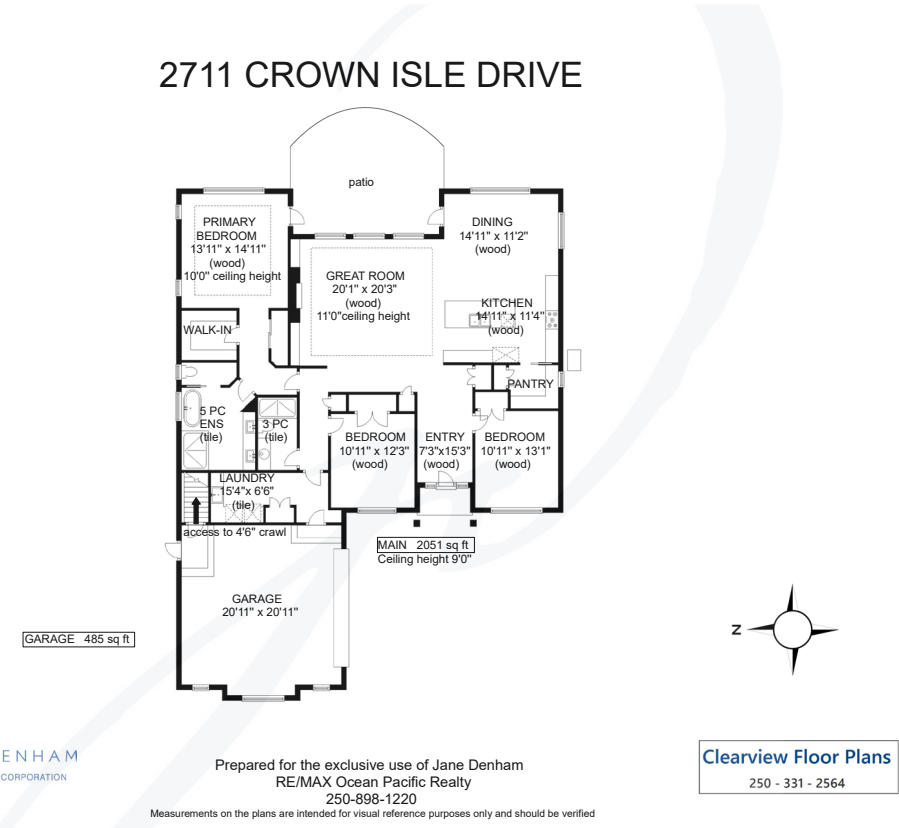

2711 Crown Isle Drive



Exquisite New Rancher...

Exquisite new rancher, located in Cambridge Park in Crown Isle, capturing glorious sunsets & West views across the park to the Beaufort Mountains. This stunning home of 2,061 sf, 3 BD/ 2 BA, incorporates exquisite craftsmanship & refined elegance for comfort without compromise. Streaming sunlight highlights the bright open concept w/ 11' coffered ceilings in the Great room, contemporary finishes include the linear gas fireplace w/ quartz feature wall, built-ins, spectacular lighting, impressive millwork, & engineered wood plank flooring. Bright white kitchen cabinets to the ceiling, drawers, waterfall style island, Butler's pantry, Bosch s/s appliances w/ gas range. The master suite offers access to the covered patio w/ tranquil forest views, a 5 pce ensuite w/ dual sinks, glass & tiled shower, free standing tub, W/C. Heat pump, HRV, H/W on demand, irrigation, N/H Warranty, fenced, landscaped, int sprinklers. Proudly built by Wahe Guru Homes, a premier builder in Crown Isle since 2013.



2711 Crown Isle Drive | Listed at \$1,350,000

MLS #: 917499 | 3 Bedrooms | 2 Bathrooms

Total SqFt: 2,061
Garages: 2
Lot Size: 0.16 acres
Year Built: 2022
Zoning: CD-1H

Please use the link below for property photos & virtual tour:
<https://www.janedenham.com/property/2711-crown-isle-drive/>



c 250.898.1220
jane@janedenham.com
www.janedenham.com

Grace Denham-Clare
c 250.897.8890
grace@janedenham.com



RE/MAX[®]

ocean pacific realty

Each Office Independently Owned and Operated

b 250.339.2021
tf 888.829.7205
282 Anderton Rd.
Comox BC V9M 1Y2