

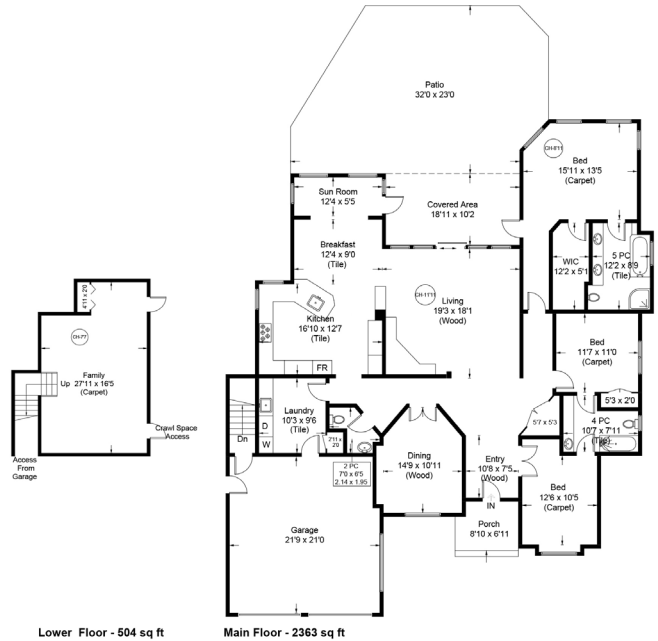

3024 Kensington Crescent



3024 Kensington Crescent

Floor Area is calculated including the external walls (GEA). All measurements are approximate and the plan is for layout guidance only. Buyers should verify all measurements.

Prepared for the exclusive use of Jane Denham
RE/MAX Ocean Pacific Realty
250-898-1220

Floor	AREA (Sq. Ft.)		
	Finished	Unfinished	Garage
Lower	504	0	0
Main	2363	0	479
Total	2867	0	479

LSPMedia

Spectacular Location on the 13th Fairway...

Spectacular location on the 13th fairway, showcasing expansive southern views of the Beaufort Mountains and Crown Isle’s Platinum rated golf course. Custom built and meticulously maintained, a stunning rancher of 3 BD/ 3 BA, 2,867 sf including a lower-level family room w/ easy access to abundant storage. Built for entertaining with a covered patio & skylights, ideal for sunset dining and after golf cocktails. Spacious living room with 12’ tray ceiling, impressive millwork and cabinetry, 3-sided gas fireplace, maple hardwood. The discerning chef will love this beautifully designed kitchen with 5 burner gas cooktop, built-in oven/microwave, wine fridge, granite counters and fairway views! The adjacent breakfast nook and lovely sunroom boast California shutters and a peaceful retreat for morning coffee and a great book. Primary bedroom offers fantastic views, patio access and luxury ensuite with dual sinks and heated tile floor. H/W tank 2019, Heat pump, electric furnace ~ 2007.



3024 Kensington Crescent | Listed at \$1,230,000

MLS #: 926379 | 3 Bedrooms | 3 Bathrooms

Total SqFt: 2,867

Garages: 2

Lot Size: 0.20 acres

Year Built: 2002

Zoning: CD-1B

Please use the link below for property photos & video:

<https://www.janedenham.com/property/3024-kensington-crescent/>



c 250.898.1220
jane@janedenham.com
www.janedenham.com

Grace Denham-Clare
c 250.897.8890
grace@janedenham.com



RE/MAX

ocean pacific realty

Each Office Independently Owned and Operated

b 250.339.2021
tf 888.829.7205
282 Anderton Rd.
Comox BC V9M 1Y2