

jane denham
REAL ESTATE GROUP

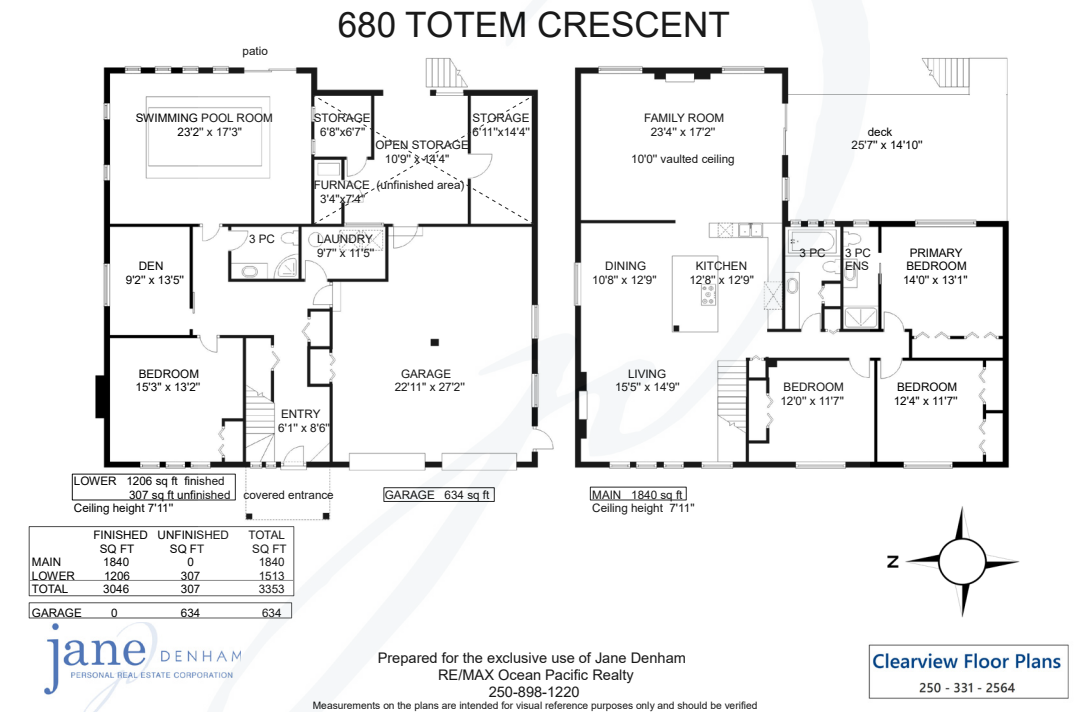

680 Totem Crescent



West Coast Styling...

West Coast Styling, Timber Frame details & commanding mountain views! This beautifully renovated family home of 3,353 sf, 4 BD/ 3 BA offers an open plan with 10' vaulted T & G ceiling in the Great room, stunning kitchen with bright white modern shaker cabinets, butcher block counters and s/s appliances, including gas cooktop on the island w/ abundant workspace. Adjacent living room w/ gas fireplace & traditional mantle showcase expansive mountain and glacier views. With 3 large bedrooms on the main floor, & 1 bedroom and den on the lower level, there's room for the full family. The indoor Swim Spa 14' x 7' provides jets for swimming or adjust the heat and enjoy as a hot tub! The upper deck overlooks the terraced yard and gardens with raised beds, and the oversized garage 23' x 27' offers additional storage/workshop for lots of storage. Gas boiler heats hot water radiators, & heat pump for A/C. Desirable location close to schools, trails, beaches, downtown and the airport!



680 Totem Crescent | Listed at \$1,030,000

MLS #: 955745 | 4 Bedrooms | 3 Bathrooms

Total SqFt: 3,046

Garages: 2

Year Built: 1981

Zoning: R1.1

Please use the link below for more information:

www.janedenham.com



c 250.898.1220
jane@janedenham.com
www.janedenham.com

Grace Denham-Clare
c 250.897.8890
grace@janedenham.com



RE/MAX[®]

ocean pacific realty

Each Office Independently Owned and Operated

b 250.339.2021
tf 888.829.7205
282 Anderton Rd.
Comox BC V9M 1Y2